

Assmby Instruction

Wall Cabinet – Double Door

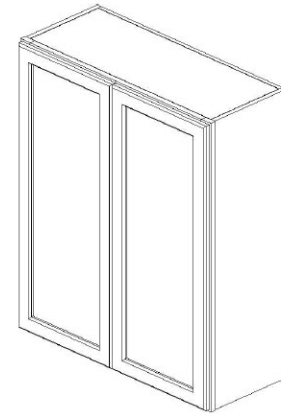

Code	Description	Qty.
A	Side Panel (L/R)	2
B	Front Frame	1
C	Back Panel	1
D	Bottom/Top Panel	2
E	Door	2
F	Shelf (Qty. depends on Cabinet height)	1 or 2 or 3
G	Plastic Shelf Clips (Qty. depends on Shelf quantity)	4 or 8 or 12
H	Hinges	4



For Product lines:
 Modern Gray/Frenso Gray Shaker/Anahiem
 Gray/Beech Espresso/Cinnamon Shaker

Required Tools:

Power Drill



EASY ASSEMBLY METAL CLIP SYSTEM

- Align Clips ① and ②
- Slide ① into ②
- Insert locking screw into clip pair
- Tighten all screws

Step-by-Step Instruction:

Step 1	Step 2
<p>Lay Front Frame (B) flat, grooves facing upward</p> <p>Insert Side panels (A) on (B) and secure with metal clips (Refer to Metal clip system above)</p>	<p>Slide bottom/Top panels (D) into grooves of A and B</p>

Assmly Instruction

Wall Cabinet – Double Door

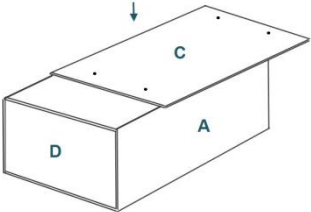
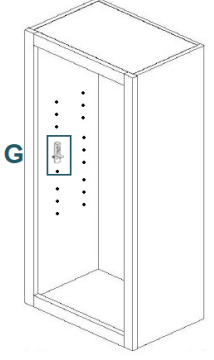
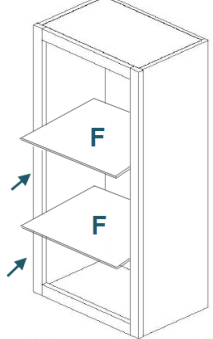

Step 3		Step 4	
<p>Inseter back panel (C) onto A and D and secure with Metal Clips (Referal to metal clip system above)</p> <p>Secure with screws on back panel</p>		<p>Insert Plastic shelf clips (G) onto pre-drilled holds on Side panels A</p>	
Step 5		Step 6	
<p>Side in shelf (F) and make sure the finished front edge facing out</p>		<p>Attach Hinge (H) on the face frame, install door (E) onto hinge on both side</p>	