

# Assmby Instruction

## Pantry Bottom – Single Door

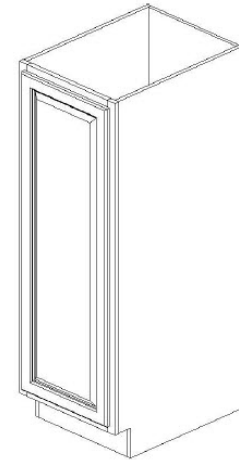

Code	Description	Qty.
A	Side Panel (L/R)	2
B	Front Frame	1
C	Back Panel	1
D	Bottom/Top Panel	2
E	Toe Kick	1
F	Door	1
G	Shelf	2
H	Plastic Shelf Clips	8
I	Hinges	3



**For Product lines:**  
 Modern Gray/Frenso Gray Shaker/Anaheim Gray/Beech Espresso/Cinnamon Shaker

### Required Tools:

Power Drill



**EASY ASSEMBLY METAL CLIP SYSTEM**

- Align Clips ① and ②
- Slide ① into ②
- Insert locking screw into clip pair
- Tighten all screws

### Step-by-Step Instruction:

Step 1		Step 2	
<p>Lay back panel (C) flat, grooves facing upward</p> <p>Insert Side panels (A) on (C) and secure with metal clips (Refer to Metal clip system above)</p>		<p>Slide bottom/Top panels (D) into grooves of A and C</p>	

# Assmly Instruction

## Pantry Bottom – Single Door

<p><b>Step 3</b></p> <p>Attach Front frame (B) onto (A)          Attach Toe kick (E) onto bottom front of (A)          (Referal to metal clip system above)</p>		<p><b>Step 4</b></p> <p>Insert Plastic shelf clips (H) onto pre-drilled holds on Side panels A</p>	
<p><b>Step 5</b></p> <p>Side in shelf (G) and make sure the finished front edge facing out</p>		<p><b>Step 6</b></p> <p>Attach Hinge (I) on the face frame, install door (F) onto hinge on both side</p> <p><i>*This step can be done after assembled pantry upper and bottom together*</i></p>	

### Pantry Upper and Bottom assembly:

<p><b>Step 1</b></p> <p>Put Pantry upper on top of Pantry bottom and install both units to the wall.</p>		<p><b>Step 2</b></p> <p>Secure both units with Nail gun, nail from the Pantry bottom upper frame and goes upward.</p>	
--	--	---	--