

Assmly Instruction

Pantry Bottom – Double Door

Code	Description	Qty.
A	Side Panel (L/R)	2
B	Front Frame	1
C	Back Panel	1
D	Bottom/Top Panel	2
E	Toe Kick	1
F	Door	2
G	Shelf	2
H	Plastic Shelf Clips	8
I	Hinges	3

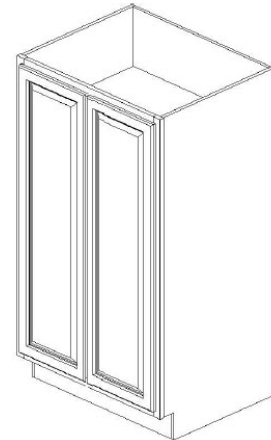

For Product lines:
 Modern Gray/Frenso Gray Shaker/Anaheim
 Gray/Beech Espresso/Cinnamon Shaker

Required Tools:

Power Drill



EASY ASSEMBLY METAL CLIP SYSTEM

- Align Clips ① and ②
- Slide ① into ②
- Insert locking screw into clip pair
- Tighten all screws

Step-by-Step Instruction:

Step 1		Step 2	
<p>Lay back panel (C) flat, grooves facing upward</p> <p>Insert Side panels (A) on (C) and secure with metal clips (Refer to Metal clip system above)</p>		<p>Slide bottom/Top panels (D) into grooves of A and C</p>	

Assmly Instruction

Pantry Bottom – Double Door



<p>Step 3</p> <p>Attach Front frame (B) onto (A) Attach Toe kick (E) onto bottom front of (A) (Referal to metal clip system above)</p>		<p>Step 4</p> <p>Insert Plastic shelf clips (H) onto pre-drilled holds on Side panels A</p>	
<p>Step 5</p> <p>Side in shelf (G) and make sure the finished front edge facing out</p>		<p>Step 6</p> <p>Attach Hinge (I) on the face frame, install door (F) onto hinge on both side</p> <p><i>*This step can be done after assembled pantry upper and bottom together*</i></p>	

Pantry Upper and Bottom assembly:

<p>Step 1</p> <p>Put Pantry upper on top of Pantry bottom and install both units to the wall.</p>		<p>Step 2</p> <p>Secure both units with Nail gun, nail from the Pantry bottom upper frame and goes upward.</p>	
--	--	---	--