

Assmby Instruction

Oven Cabinet

Code	Description	Qty.
A	Side Panel (L/R)	2
B	Front Frame	1
C	Back Panel	1
D	Bottom/Top Panel	2
E	Shelf	2
F	Toe Kick	1
G	Drawer Box (Side/bottom panels)	1 Set
H	Drawer Face	1
I	Door	2
J	Sliders & Adapter	2 pairs
K	Plastic Slider holder	2
L	Hinges	4

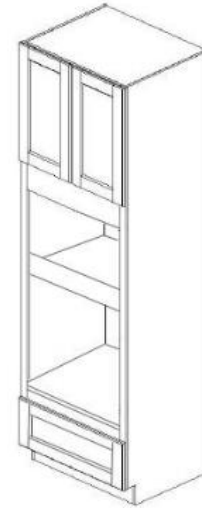

For Product lines:

Ice White Shaker/Cambridge White Raised/ Ashton Gray Shaker/Driftwood Gray Raised/Antique White

Required Tools:

Nail Gun



Rubber Hammer



Power Drill



Step-by-Step Instruction:

Step 1		Step 2	
<p>Lay front frame (B) flat, grooves facing upword (on a soft flat working surface to avoid scratching the face)</p> <p>Slide side panel (A) to the grooves</p>		<p>Slide D into grooves of A and B</p>	

Assmly Instruction

Oven Cabinet

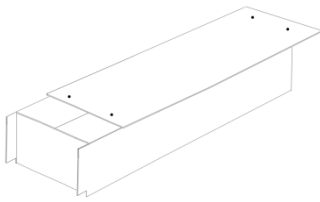
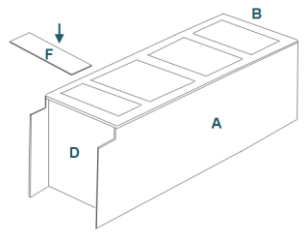
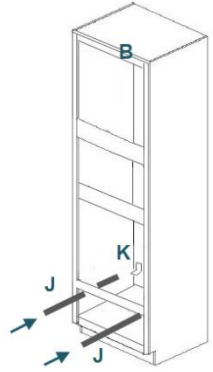
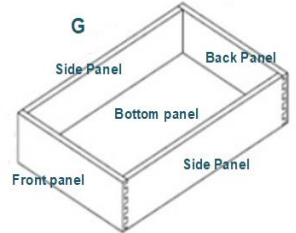
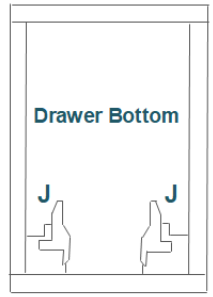
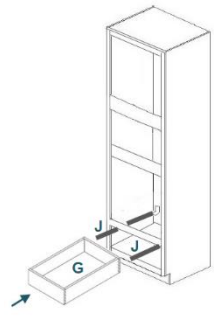

<p>Step 3</p> <p>Slide back panel (C) into grooves of A and D and secure with Nail Gun (<i>use metal clip if no nail gun</i>)</p> <p>Secure with screws from the upper and bottom of back panel (C)</p>		<p>Step 4</p> <p>Attach F onto A and secure with Nail Gun</p>	
<p>Step 5</p> <p>Screw both rear slider holder brackets (K) into pre-drill holes in C, angle facing upward</p> <p>Install sliders (J) into K and screw into the side of B</p>		<p>Step 6</p> <p>Assemble the drawer box by using Rubber Hammer</p> <p><i>*Use wood glue for a permanent bond*</i></p>	
<p>Step 7</p> <p>Attach Plastic Adapter (J) underneath the drawer</p> <p>There will be a letter indicating L or R side</p>		<p>Step 8</p> <p>Position Drawer box G over drawer sliders J</p>	

Assmby Instruction

Oven Cabinet

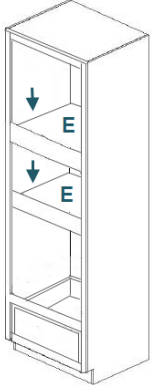

Step 9		Step 10	
<p>Insert shelf (E) behind the front frame</p>		<p>Attach Drawer face (H) onto drawer front</p> <p>Attach Hinge (L) on the face frame, install door (I) onto hinge</p>	