

# Assmby Instruction

## Pantry

Code	Description	Qty.
A	Side Panel (L/R)	2
B	Front Frame	1
C	Back Panel	1
D	Bottom/Top Panel	2
E	Toe Kick	1
F	Door	1 or 2
G	Shelf	2
H	Plastic Shelf Clips	8
I	Hinges	3 or 6

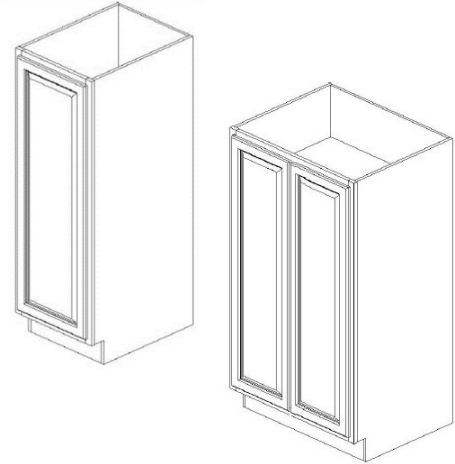

*This cabinet need to combine with Pantry upper  
To make a full pantry cabinet.*

### For Product lines:

Modern Gray/Frenso Gray Shaker/Anaheim  
Gray/Beech Espresso

## Required Tools:

Power Drill



## Step-by-Step Instruction:

Step 1	Step 2
<p>Lay back panel (C) flat, grooves facing upward</p> <p>Insert Side panels (A) on (C) and secure with metal clips (Refer to Metal clip system above)</p>	<p>Slide bottom/Top panels (D) into grooves of A and C</p>

# Assmby Instruction

## Pantry

<b>Step 3</b>		<b>Step 4</b>	
<p>Attach Front frame (B) onto (A)</p> <p>Attach Toe kick (E) onto bottom front of (A)</p> <p>(Referal to metal clip system above)</p>		<p>Insert Plastic shelf clips (H) onto pre-drilled holds on Side panels A</p>	
<b>Step 5</b>		<b>Step 6</b>	
<p>Side in shelf (G) and make sure the finished front edge facing out</p>		<p>Attach Hinge (I) on the face frame, install door (F) onto hinge on both side</p> <p><i>*This step can be done after assembled pantry upper and bottom together*</i></p>	

### Pantry Upper and Bottom assembly:

<b>Step 1</b>		<b>Step 2</b>	
<p>Put Pantry upper on top of Pantry bottom and install both units to the wall.</p>		<p>Secure both units with Nail gun, nail from the Pantry bottom upper frame and goes upward.</p>	